

## Outdoor lighting Bollard Luminaires

Lumen output selectable, CCT selectable(3000K-4000K)



### Description:

Modular bollard luminaire available as fixed-output/fixed-CCT or field-selectable power & CCT versions, in two clean silhouettes—Type A rounded cap and Type B flat cap. Choice of 360 ° or 180 ° distributions (< 2 % uplight); a clip-on 180 ° glare shield converts the 360 ° model for single-sided scenes, minimising SKUs. Heights scale with lumen package. Rugged construction—IP66 light engine, IP67 built-in driver, IK08 impact and corrosion-resistant powder coat—ensures long-term performance in harsh outdoor conditions. Factory options include PIR sensor, emergency module and waterproof junction box; pre-wired gland outlets speed on-site installation.

### Specifications:

Indoor/Outdoor	Outdoor
Product No.:	ABL170A (Dome head) & ABL170B (Flat head)
Input Voltage:	220-240Vac / 50-60 Hz
System Power:	6W/12W/18W/24W(Lumen output selectable)
Type of light source:	Lumiled SMD LED
Color Rendering(CRI):	Ra 80 SDCM<5
CCT:	3000K / 4000K / 3000K & 4000K selectable
System Lumen:	780-2640lm(Dome Head) / 360-1200lm(Flat head)
System Efficacy:	100-130lm/W(Dome head) / 50-70lm/W(Flat head)
Light Distribution:	Asymmetric
Beam Angle:	Asymmetric
UGR (4H 8H):	
IP Rating:	IP66
Color:	Black
Luminaire Lifetime:	50,000h (L80B50, Ta25°C)
Working Temperature:	-25 ~ +50 °C
Material:	Die casting aluminum + 6063 AL
Electrical Class	I
Photobiological Safety:	Risk Group 1
Dimming:	ON-OFF, Optional:0/1-10V Dimming, DALI
Warranty:	5 years

### Mounting / Connection:

Mounting:	to recessed in ground, Outdoor
Cut-out:	Ground mounting
Connection:	

### Packaging Information:

N.W. Fixture (Kg)	
G.W. Carton	
Mater Carton Dimension:	
Qty per Carton:	

### Photometrics

Please download from the website or consult the sales manager.

### Ordering Information:

Model	Fixture head	Easy for stock or not	Wattage	Color Rendering	CCT	Beam	Accessories	Dimming Options
ABL170	A Dome head B Flat head	Fixed power & single CCT Multi power & dual CCT	6W 12W 18W 24W 6-12-18-24W	8 80+ CRI	30 3000K 40 4000K 3000K & 4000K Selectable	DA Double Asymmetrical	See below	F ON-OFF V 1~10V DIM D DALI DIM

Project: \_\_\_\_\_  
 Location: \_\_\_\_\_  
 Fixture Ref.: \_\_\_\_\_  
 Quantity: \_\_\_\_\_  
 Remarks: \_\_\_\_\_

### Picture:



### Line Drawings:

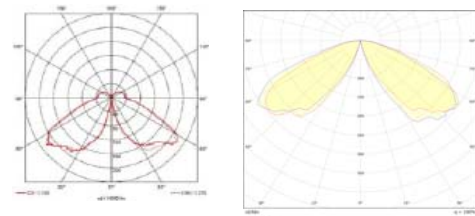
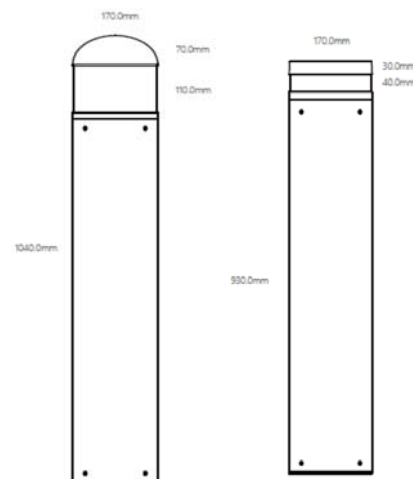

## Product Variants



Dual ingress protection of 66 on both driver enclosure and tube, suitable for residential and hospitality applications



Half-shielded version with additional backplate assembled on site to prevent spill light around neighborhood



Embedment sleeve

PHOTOMETRIC		
Imax (cd)	712.3	C
LOR (%)	100.0	C
TOTAL FLUX (lm)	2396	C
MAXIMUM @ (C, D)	120.51.0	C
up (%)	1.3	1
down (%)	98.7	8

Dark-sky code compliant with ULR (upward light ratio) less than 2%

DIP switches for multi-lumen/

Anti-drop rubber lid

cable outlet for PIR sensor

cable entry for AC power

## Product Variants-Accessories



**Emergency Pack**

--EM power: 2W,  
duration time: 3h  
--compliant with  
CE/Robe

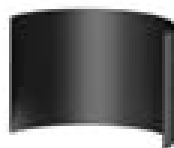

**Half-shield cover A**

--for Domed head  
--Material:  
aluminium



**Half-shield cover B**

--for Flat head  
--Material:  
aluminium



**Embedment sleeve**

To recessed into  
ground



**PIR sensor**

--PIR sensor  
--IP65



**Remote control**

Remote control



**Junction box**

IP65